

**ADVERTISEMENT FOR BIDS
CLARE COUNTY ROAD COMMISSION
PAVEMENT MARKING**

Bids will be received by the Board of County Road Commissioners of Clare County, Michigan at their office at 3900 E. Mannsiding Road, Harrison, Michigan, 48625, 989-539-2151; until 9:30 a.m., E.S.T., on Thursday, September 10 , 2020 and then publicly opened and read for the annual requirements of the following:

PAVEMENT MARKING

Bids shall be in accordance with the specifications, obtainable from the Road Commission office. Bids shall be submitted upon the forms provided. Bids shall be submitted in sealed envelopes plainly marked on the outside as to their contents.

The Board reserves the right to reject any and all bids and waive any defects and accept the bid which in their opinion is in the best interest of the Clare County Road Commission.

**BOARD OF COUNTY ROAD COMMISSIONERS
of Clare County, Michigan**

**Richard Haynak, Chair
Tim Haskin, Vice-Chair
Karen Hulliberger, Member
Merle Harmon, Member
Bill Simpson, Member**

INFORMATION FOR BIDDERS
CLARE COUNTY ROAD COMMISSION
PAVEMENT MARKING

PURPOSE

The intent of these specifications is to provide pavement marking to meet the Clare County Road Commission's seasonal requirements.

SPECIFICATIONS

Pavement marking shall meet the requirements of the Michigan Department of Transportation (MDOT) Specifications of latest revision. Marking shall include all layout work including the establishment of zones.

Contractors shall be on the current list of prequalified bidders for pavement marking.

SCHEDULING & COMPLETION

Unless otherwise noted, all roads are ready for pavement marking and work shall be completed by October 15, 2020.

RENEWAL OPTION

The Clare County Road Commission reserves the right to renew its Award of Bid for one-year extension(s), up to 3 separate additional years, subject to satisfactory performance of the work.

MATERIALS AND APPLICATION

Paint system shall be Waterborne pavement marking material. Materials shall be from MDOT Qualified Product List. Paint shall be applied at a minimum rate of 16 gallons per mile. Glass beads shall be applied at the minimum rate of 8 pounds per gallon of paint.

Railroad pavement markings shall include the "RXR" symbol and three transverse crossbars in reflectorized white paint. Unit price shall be for one lane on one side of the crossing. The work shall include layout and shall be in accordance with the latest revision of the Michigan Manual of Uniform Traffic Control Devices.

QUANTITIES

Approximately 70 miles of bituminous pavement are involved with the pavement marking program. Quantities are estimated and are subject to increase, decrease, or deletion. Bidders may state the minimum quantity for which the unit prices are applicable.

MEASUREMENT AND PAYMENT

The completed work shall be measured and paid for at the unit prices listed on the bid sheet. The skips in dashed lines are not included in the measurements.

**BID SHEET
CLARE COUNTY ROAD COMMISSION
PAVEMENT MARKING**

BIDS DUE 9:30 a.m., 9/10/2020

The bidder agrees to furnish pavement marking in accordance with the Advertisement, Information for Bidders and Special Provisions for the following unit prices and terms:

Item No.	Description	Unit	Est. Qty.	Unit Price
1.	Waterborne, 4 inch, yellow	foot	370,000	_____
2.	Waterborne, 4 inch, white	foot	740,000	_____
3.	Railroad Crossings	ea.	4	_____
4.	Stop Bars	ea.	2	_____
5.	Crosswalks	ea.	1	_____
			TOTAL	_____

TERMS:

BIDDER:

BY:

Company Name

Signature

Address

Name printed or typed

City State Zip

Title

Telephone

Facsimile

Date

E-mail

2020 Line Striping

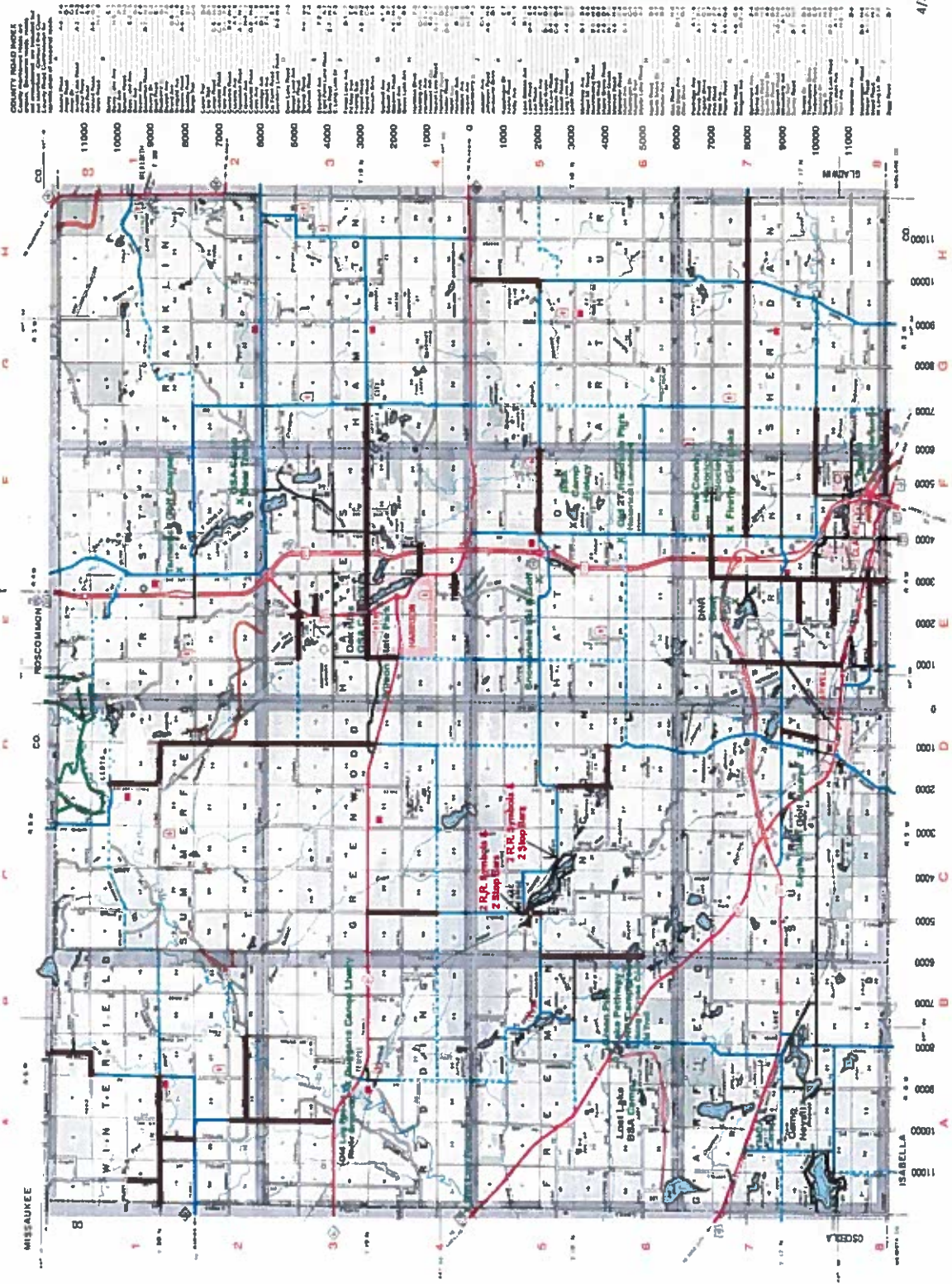

COUNTY ROAD INDEX

County	Route No.	Route Name	Length (Miles)
Alcona	1	Alcona	10.0
	2	Alcona	10.0
	3	Alcona	10.0
	4	Alcona	10.0
	5	Alcona	10.0
	6	Alcona	10.0
	7	Alcona	10.0
	8	Alcona	10.0
	9	Alcona	10.0
	10	Alcona	10.0
Alcona	1	Alcona	10.0
	2	Alcona	10.0
	3	Alcona	10.0
	4	Alcona	10.0
	5	Alcona	10.0
	6	Alcona	10.0
	7	Alcona	10.0
	8	Alcona	10.0
	9	Alcona	10.0
	10	Alcona	10.0

LEGEND

- Center & Edge Line Striping
- 4 Stop Bars
- 2 R.R. Symbols
- U.S. STATE HIGHWAYS
- COUNTY PRIMARY ROADS
- COUNTY LOCAL ROADS
- COUNTY LOCAL GRANTS
- COUNTY UNIMPAVED
- UNIMPAVED TRAIL
- CITY TRAIL
- CLARE COUNTY BOUND & LINDSAY TOWNSHIP BOUNDARY
- STATE LAND
- TOWNSHIP HALL
- CEMETERY

CLARE COUNTY MICHIGAN

ROAD MAP
Scale Quarter
50¢

4/30/2020